



The London Resort Development Consent Order

BC080001

Trees and Hedgerows which may be Removed or may be Affected Plans

Document reference: 2.16
Revision: 0

December 2020

Planning Act 2008
The Infrastructure Planning (Applications: Prescribed Forms and Procedure) Regulations 2009
Regulations 5(2)(o)

[This page is intentionally left blank]



Key

- Order limits
- Local Authority Boundary
- Area outside Order Limits

Apt

235 St John Street London EC1V 4NG www.aplondon.com

Project: The London Resort Project No: 19072

Disclaimer
Do not scale from this drawing. Check all dimensions on site before fabrication or setting out. This document is copyright and may not be reproduced without permission of the owner.

REPRODUCED FROM ORDNANCE SURVEY MAPS, BY PERMISSION OF THE ORDNANCE SURVEY ON BEHALF OF THE CONTROLLER OF HER MAJESTY'S STATIONERY OFFICE. CROWN COPYRIGHT ORDNANCE SURVEY LICENCE NO. 0100031673

© CROWN COPYRIGHT AND DATABASE RIGHT 2020
© LOCAL GOVERNMENT INFORMATION HOUSE LIMITED
COPYRIGHT AND DATABASE RIGHTS 2020

0	Issue for DCO Submission	24/12/20	Apt/TS-S
Rev	Reason for Issue	Date	Drw Chk

THE LONDON RESORT DEVELOPMENT CONSENT ORDER
Regulation 5(2)(a) – Location Plan
DARTFORD BOROUGH COUNCIL, GRAVESHAM BOROUGH COUNCIL AND THURROCK COUNCIL
Sheet 1 of 1

Application Number
BC080001
Drawing Reference
LR-PL-APT-DCP-2.1
Scale
1 : 12500 @ A1
Sheet
1 of 1
Revision
0

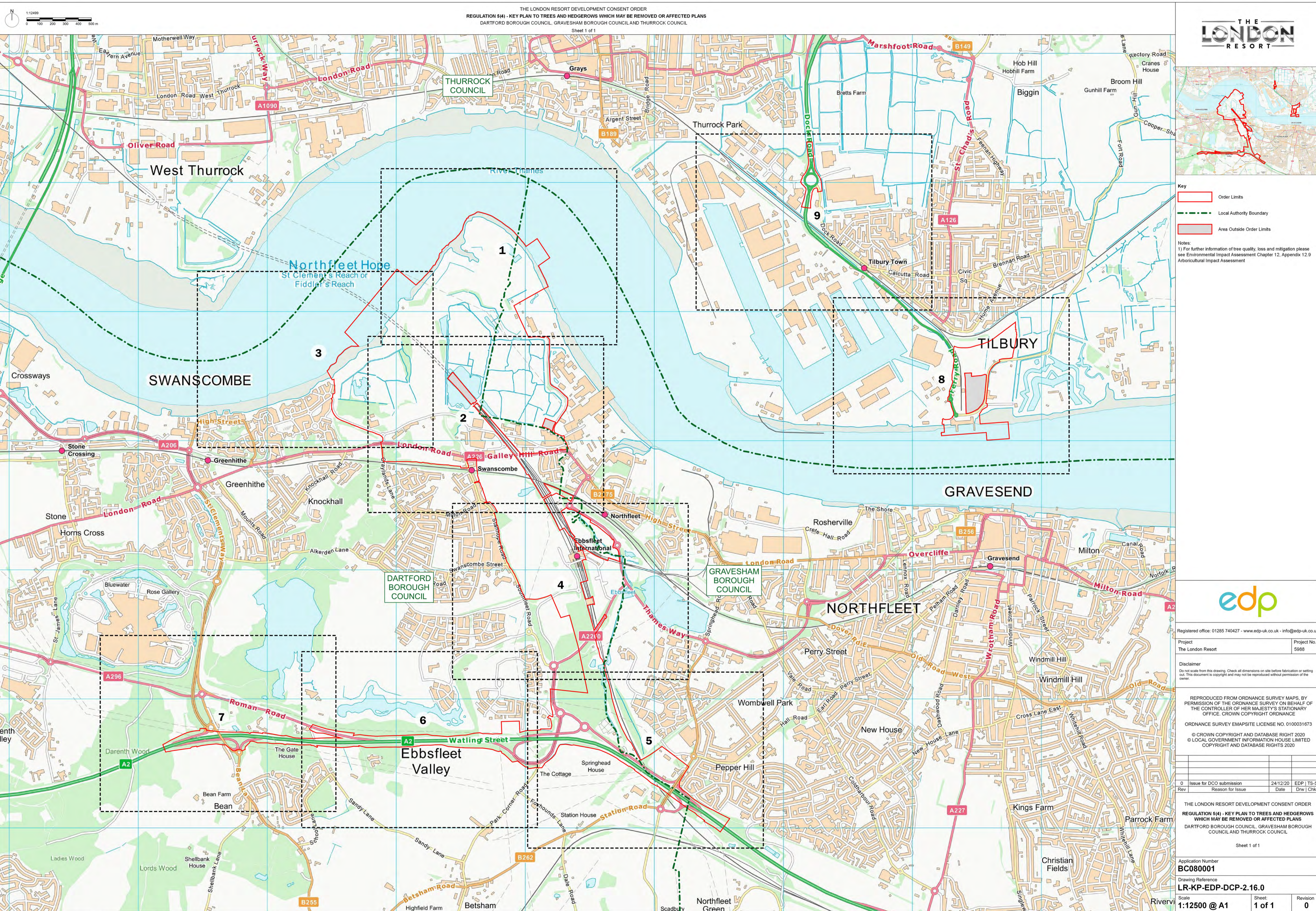

- Key
- Order Limits
 - Local Authority Boundary
 - Area Outside Order Limits

Notes:
 1) For further information of tree quality, loss and mitigation please see Environmental Impact Assessment Chapter 12, Appendix 12.9 Arboricultural Impact Assessment



Registered office: 01285 740427 - www.edp-uk.co.uk - info@edp-uk.co.uk

Project: The London Resort
 Project No: 5988

Disclaimer
 Do not scale from this drawing. Check all dimensions on site before fabrication or setting out. This document is copyright and may not be reproduced without permission of the owner.

REPRODUCED FROM ORDNANCE SURVEY MAPS, BY PERMISSION OF THE ORDNANCE SURVEY ON BEHALF OF THE CONTROLLER OF HER MAJESTY'S STATIONARY OFFICE. CROWN COPYRIGHT ORDNANCE

ORDNANCE SURVEY EMAPSITE LICENSE NO. 0100031673
 © CROWN COPYRIGHT AND DATABASE RIGHT 2020
 © LOCAL GOVERNMENT INFORMATION HOUSE LIMITED COPYRIGHT AND DATABASE RIGHTS 2020

Rev	Issue for DCO submission	Reason for Issue	Date	EDP TS-S	Drw Chk
0	Issue for DCO submission		24/12/20	EDP TS-S	

THE LONDON RESORT DEVELOPMENT CONSENT ORDER
 REGULATION 5(4) - KEY PLAN TO TREES AND HEDGEROWS WHICH MAY BE REMOVED OR AFFECTED PLANS
 DARTFORD BOROUGH COUNCIL, GRAVESHAM BOROUGH COUNCIL AND THURROCK COUNCIL
 Sheet 1 of 1

Application Number: **BC080001**
 Drawing Reference: **LR-KP-EDP-DCP-2.16.0**
 Scale: **1:12500 @ A1**
 Sheet: **1 of 1**
 Revision: **0**

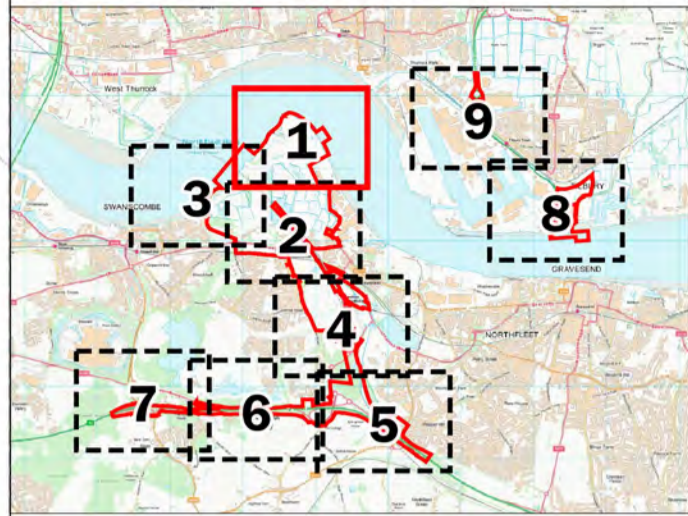
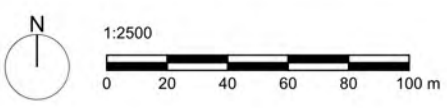

Key

	Order Limits
	Local Authority Boundary
	Individual Trees Proposed To Be Retained
	Areas of Trees and Hedgerows Proposed To Be Retained or Managed
	Areas of Trees and Hedgerows Which Will Be Removed

Notes:
 1) For further information of tree quality, loss and mitigation please see Environmental Impact Assessment Chapter 12, Appendix 12.9 Arboricultural Impact Assessment

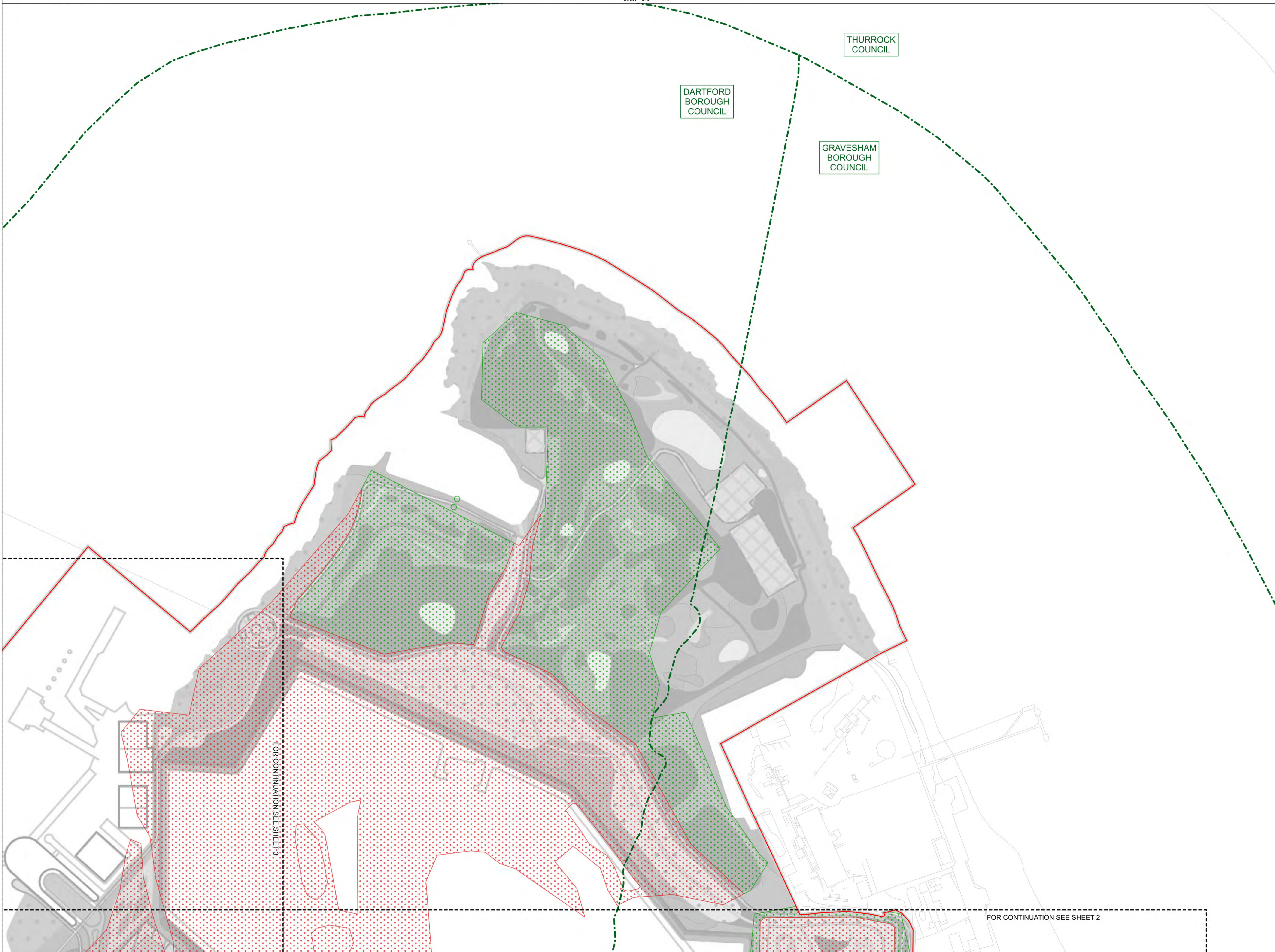

FOR CONTINUATION SEE SHEET 3

FOR CONTINUATION SEE SHEET 2



Registered office: 01285 740427 - www.edp-uk.co.uk - info@edp-uk.co.uk

Project	The London Resort	Project No.	5988
---------	-------------------	-------------	------

Disclaimer
 Do not scale from this drawing. Check all dimensions on site before fabrication or setting out. This document is copyright and may not be reproduced without permission of the owner.

REPRODUCED FROM ORDNANCE SURVEY MAPS, BY PERMISSION OF THE ORDNANCE SURVEY ON BEHALF OF THE CONTROLLER OF HER MAJESTY'S STATIONARY OFFICE. CROWN COPYRIGHT ORDNANCE SURVEY EMAPSITE LICENSE NO. 0100031673
 © CROWN COPYRIGHT AND DATABASE RIGHT 2020
 © LOCAL GOVERNMENT INFORMATION HOUSE LIMITED COPYRIGHT AND DATABASE RIGHTS 2020

Rev	Reason for Issue	Date	Drw	Chk
0	Issue for DCO submission	24/12/20	EDP	ITS-S

THE LONDON RESORT DEVELOPMENT CONSENT ORDER
 REGULATION 5(2)(a) - TREES AND HEDGEROWS WHICH MAY BE REMOVED OR AFFECTED PLANS
 DARTFORD BOROUGH COUNCIL, GRAVESHAM BOROUGH COUNCIL AND THURROCK COUNCIL
 Sheet 1 of 9

Application Number	BC080001
Drawing Reference	LR-PL-EDP-DCP-2.16.1
Scale	1:2500 @ A1
Sheet	1 of 9
Revision	0

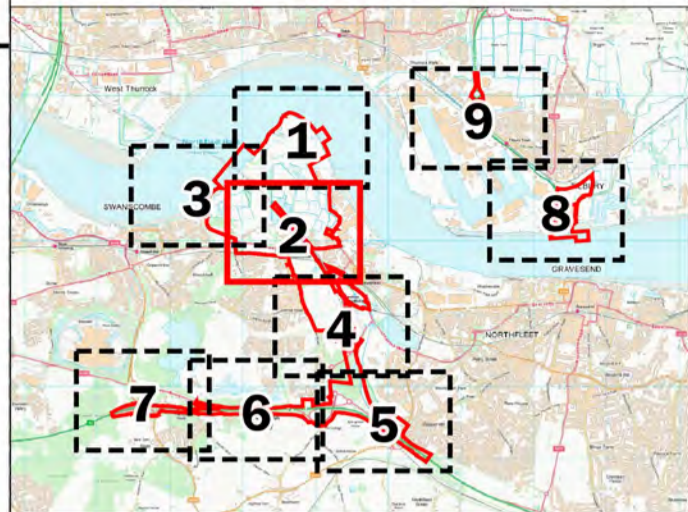
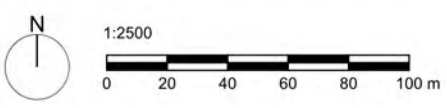

FOR CONTINUATION SEE SHEET 1

FOR CONTINUATION SEE SHEET 3

FOR CONTINUATION SEE SHEET 4

- Key**
- Order Limits
 - Local Authority Boundary
 - Area Outside Order Limits
 - Areas of Trees and Hedgerows Proposed To Be Retained or Managed
 - Area of Trees and Hedgerows Which May Be Removed
 - Individual Trees Which Will Be Removed
 - Areas of Trees and Hedgerows Which Will Be Removed

Notes:
 1) For further information of tree quality, loss and mitigation please see Environmental Impact Assessment Chapter 12, Appendix 12.9 Arboricultural Impact Assessment



Registered office: 01285 740427 - www.edp-uk.co.uk - info@edp-uk.co.uk

Project The London Resort	Project No. 5988
------------------------------	---------------------

Disclaimer
 Do not scale from this drawing. Check all dimensions on site before fabrication or setting out. This document is copyright and may not be reproduced without permission of the owner.

REPRODUCED FROM ORDNANCE SURVEY MAPS, BY PERMISSION OF THE ORDNANCE SURVEY ON BEHALF OF THE CONTROLLER OF HER MAJESTY'S STATIONARY OFFICE. CROWN COPYRIGHT ORDNANCE SURVEY EMAPSITE LICENSE NO. 0100031673
 © CROWN COPYRIGHT AND DATABASE RIGHT 2020
 © LOCAL GOVERNMENT INFORMATION HOUSE LIMITED COPYRIGHT AND DATABASE RIGHTS 2020

Rev	Reason for Issue	Date	Drw	Chk
0	Issue for DCO submission	24/12/20	EDP	ITS-S

THE LONDON RESORT DEVELOPMENT CONSENT ORDER
 REGULATION 5(2)(a) - TREES AND HEDGEROWS WHICH MAY BE REMOVED OR AFFECTED PLANS
 DARTFORD BOROUGH COUNCIL AND GRAVESHAM BOROUGH COUNCIL
 Sheet 2 of 9

Application Number BC080001
Drawing Reference LR-PL-EDP-DCP-2.16.2
Scale 1:2500 @ A1
Sheet 2 of 9
Revision 0

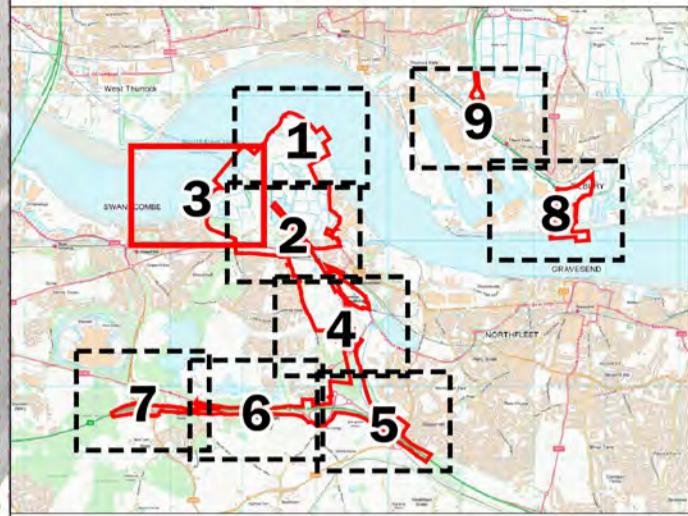
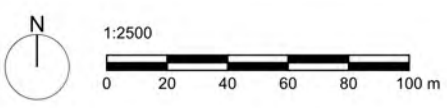

Key

- Order Limits
- Local Authority Boundary
- Areas of Trees and Hedgerows Proposed To Be Retained or Managed
- Individual Trees Which Will Be Removed
- Areas of Trees and Hedgerows Which Will Be Removed

Notes:
 1) For further information of tree quality, loss and mitigation please see Environmental Impact Assessment Chapter 12, Appendix 12.9 Arboricultural Impact Assessment

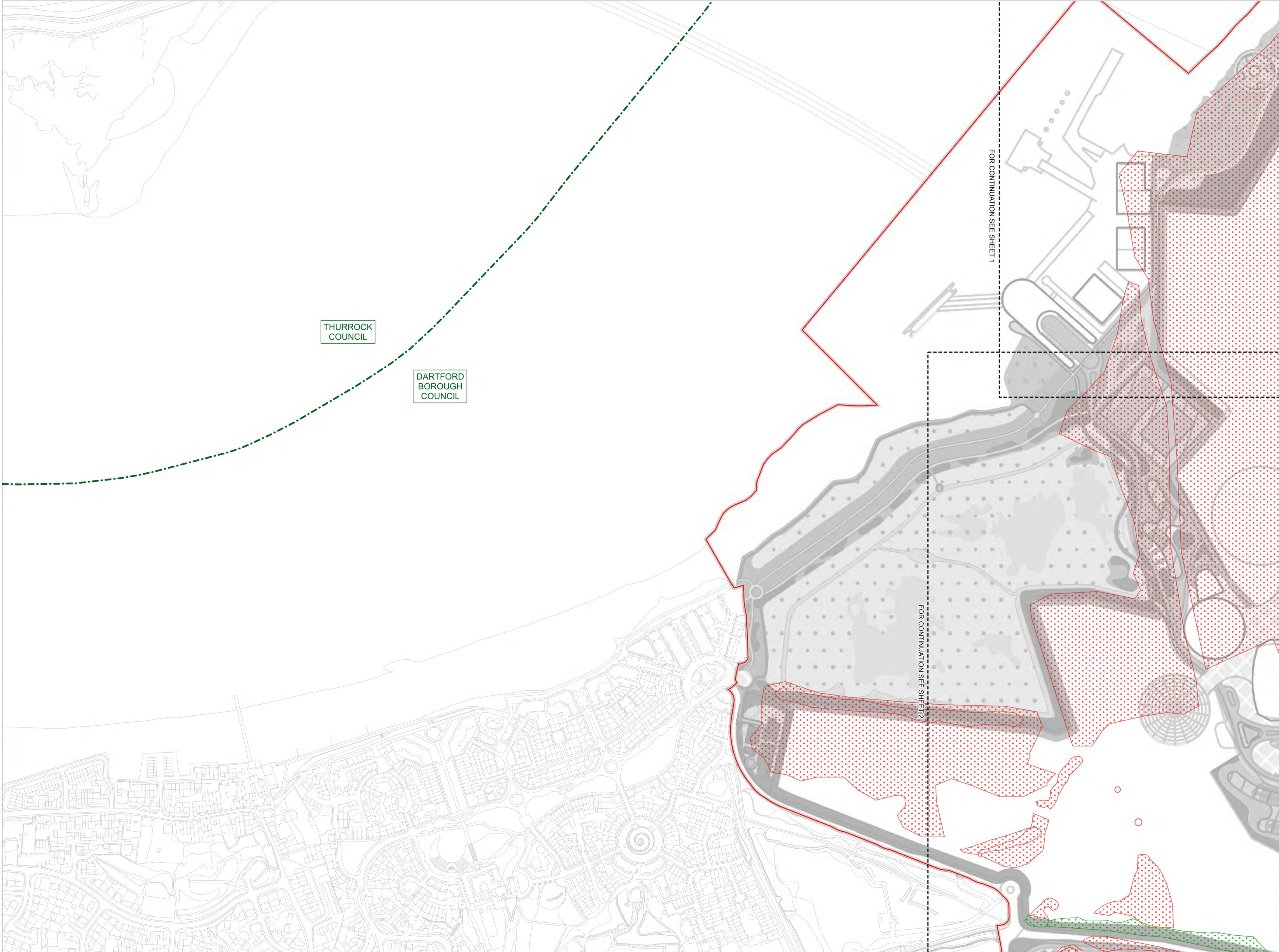

Registered office: 01285 740427 - www.edp-uk.co.uk - info@edp-uk.co.uk

Project	The London Resort	Project No.	5988
---------	-------------------	-------------	------

Disclaimer
 Do not scale from this drawing. Check all dimensions on site before fabrication or setting out. This document is copyright and may not be reproduced without permission of the owner.

REPRODUCED FROM ORDNANCE SURVEY MAPS, BY PERMISSION OF THE ORDNANCE SURVEY ON BEHALF OF THE CONTROLLER OF HER MAJESTY'S STATIONARY OFFICE. CROWN COPYRIGHT ORDNANCE SURVEY EMAPSITE LICENSE NO. 0100031673
 © CROWN COPYRIGHT AND DATABASE RIGHT 2020
 © LOCAL GOVERNMENT INFORMATION HOUSE LIMITED COPYRIGHT AND DATABASE RIGHTS 2020

Rev	Issue for DCO submission	Reason for Issue	Date	Drw	Chk
0	Issue for DCO submission		24/12/20	EDP	ITS-S

THE LONDON RESORT DEVELOPMENT CONSENT ORDER
 REGULATION 5(2)(a) - TREES AND HEDGEROWS WHICH MAY BE REMOVED OR AFFECTED PLANS
 DARTFORD BOROUGH COUNCIL AND THURROCK COUNCIL
 Sheet 3 of 9

Application Number	BC080001
Drawing Reference	LR-PL-EDP-DCP-2.16.3
Scale	1:2500 @ A1
Sheet	3 of 9
Revision	0

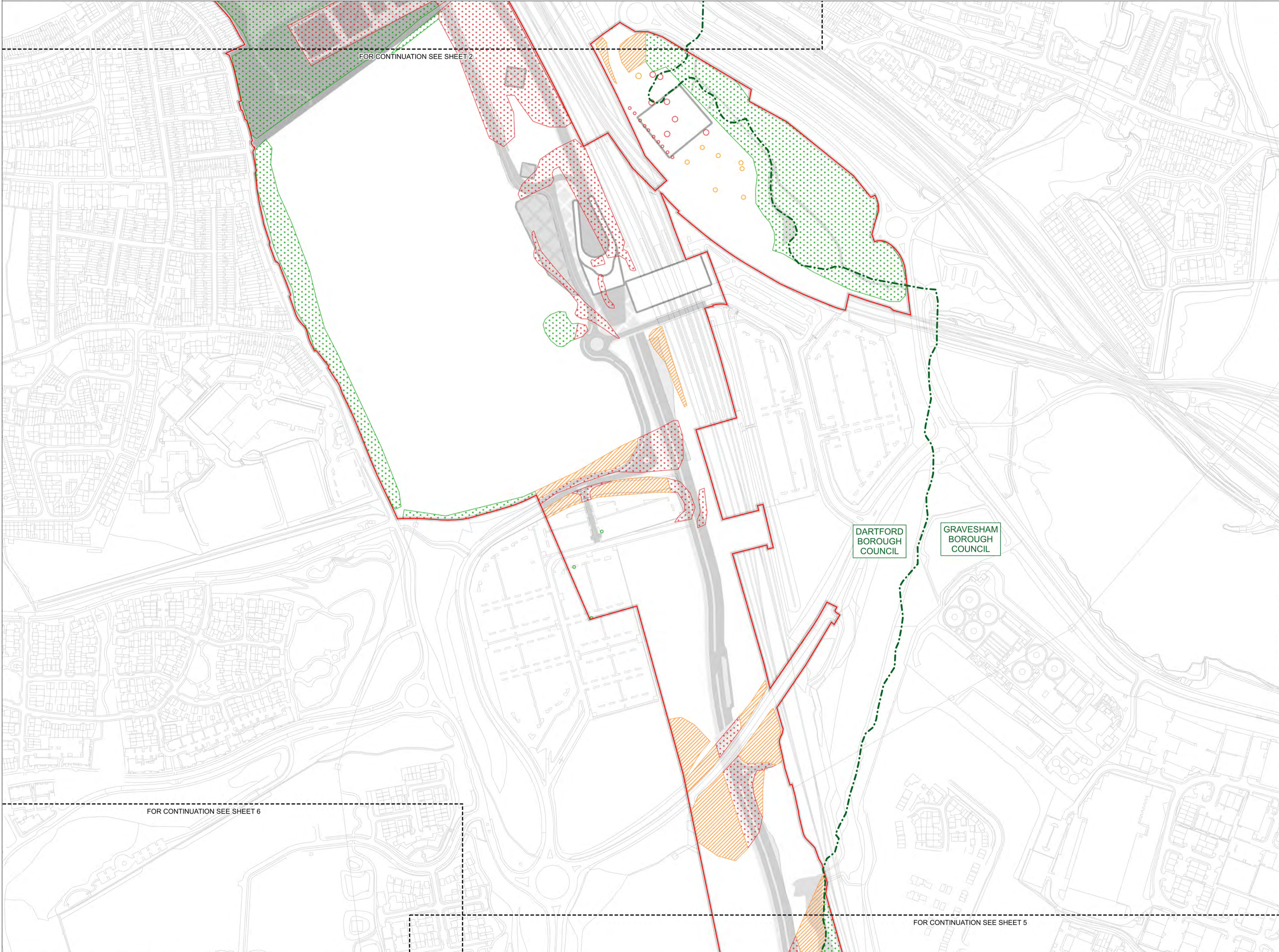
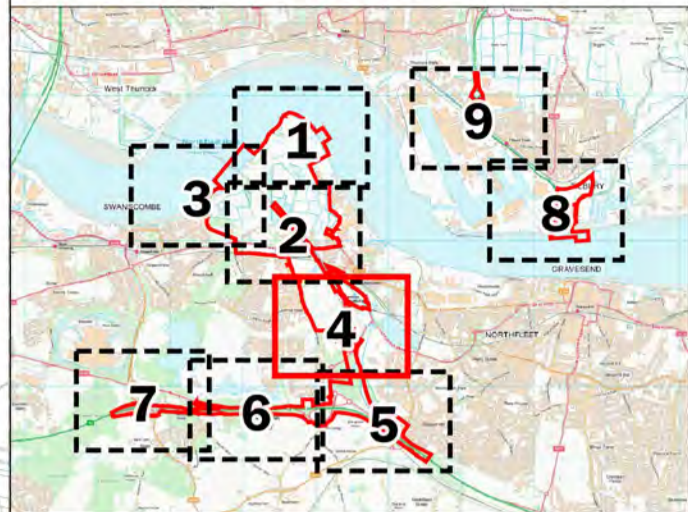
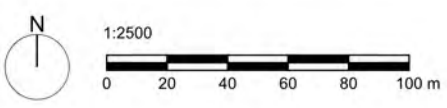

- Key**
- Order Limits
 - Local Authority Boundary
 - Individual Trees Proposed To Be Retained or Managed
 - Areas of Trees and Hedgerows Proposed To Be Retained or Managed
 - Individual Trees Which May Be Removed
 - Area of Trees and Hedgerows Which May Be Removed
 - Individual Trees Which Will Be Removed
 - Areas of Trees and Hedgerows Which Will Be Removed

Notes:
 1) For further information of tree quality, loss and mitigation please see Environmental Impact Assessment Chapter 12, Appendix 12.9 Arboricultural Impact Assessment



Registered office: 01285 740427 - www.edp-uk.co.uk - info@edp-uk.co.uk

Project The London Resort	Project No. 5988
------------------------------	---------------------

Disclaimer
 Do not scale from this drawing. Check all dimensions on site before fabrication or setting out. This document is copyright and may not be reproduced without permission of the owner.

REPRODUCED FROM ORDNANCE SURVEY MAPS, BY PERMISSION OF THE ORDNANCE SURVEY ON BEHALF OF THE CONTROLLER OF HER MAJESTY'S STATIONARY OFFICE. CROWN COPYRIGHT ORDNANCE SURVEY EMAPSITE LICENSE NO. 0100031673

© CROWN COPYRIGHT AND DATABASE RIGHT 2020
 © LOCAL GOVERNMENT INFORMATION HOUSE LIMITED
 COPYRIGHT AND DATABASE RIGHTS 2020

Rev	Reason for Issue	Date	Drw	Chk
0	Issue for DCO submission	24/12/20	EDP	ITS-S

THE LONDON RESORT DEVELOPMENT CONSENT ORDER
 REGULATION 5(2)(a) - TREES AND HEDGEROWS WHICH MAY BE REMOVED OR AFFECTED PLANS
 DARTFORD BOROUGH COUNCIL AND GRAVESHAM BOROUGH COUNCIL
 Sheet 4 of 9

Application Number
BC080001

Drawing Reference
LR-PL-EDP-DCP-2.16.4

Scale 1:2500 @ A1	Sheet: 4 of 9	Revision 0
-----------------------------	-------------------------	----------------------

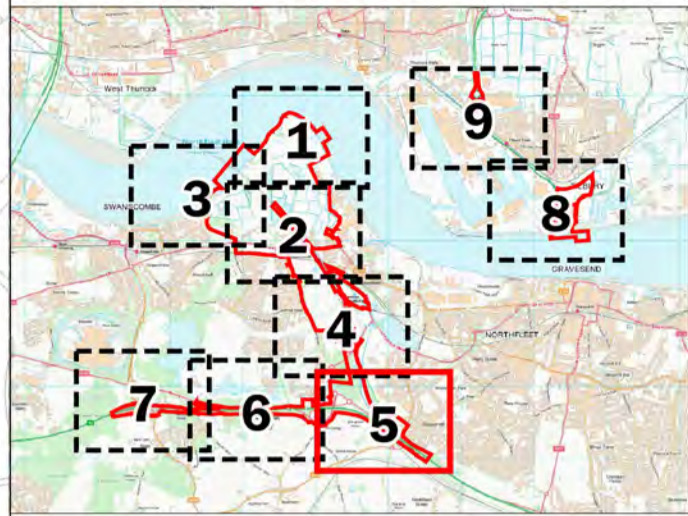
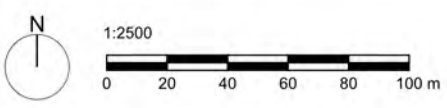

FOR CONTINUATION SEE SHEET 4

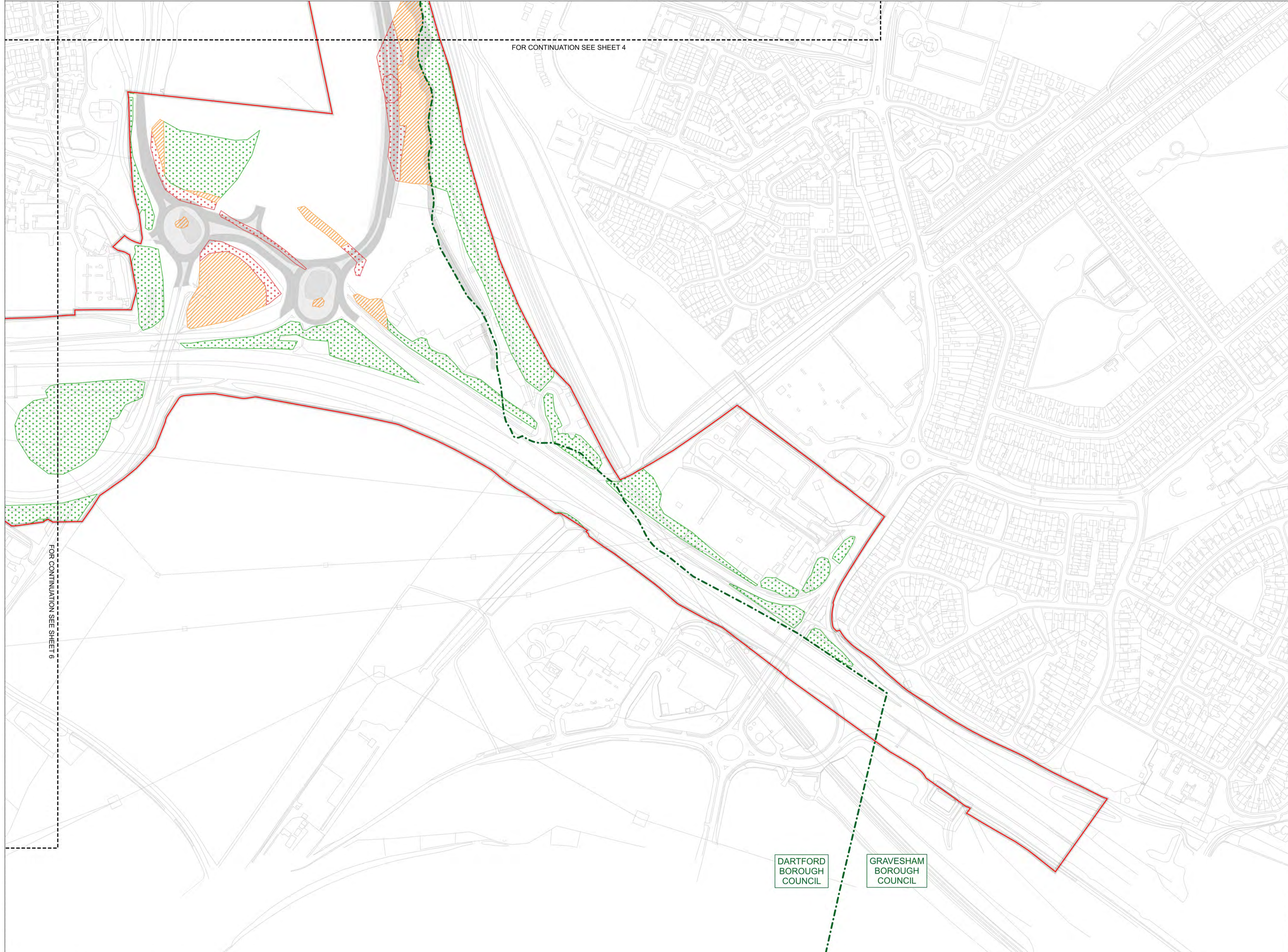

FOR CONTINUATION SEE SHEET 6

- Key**
- Order Limits
 - Local Authority Boundary
 - Areas of Trees and Hedgerows Proposed To Be Retained or Managed
 - Area of Trees and Hedgerows Which May Be Removed
 - Areas of Trees and Hedgerows Which Will Be Removed
- Notes:**
 1) For further information of tree quality, loss and mitigation please see Environmental Impact Assessment Chapter 12, Appendix 12.9 Arboricultural Impact Assessment



Registered office: 01285 740427 - www.edp-uk.co.uk - info@edp-uk.co.uk

Project	The London Resort	Project No.	5988
---------	-------------------	-------------	------

Disclaimer
 Do not scale from this drawing. Check all dimensions on site before fabrication or setting out. This document is copyright and may not be reproduced without permission of the owner.

REPRODUCED FROM ORDNANCE SURVEY MAPS, BY PERMISSION OF THE ORDNANCE SURVEY ON BEHALF OF THE CONTROLLER OF HER MAJESTY'S STATIONARY OFFICE. CROWN COPYRIGHT ORDNANCE SURVEY EMAPSITE LICENSE NO. 0100031673
 © CROWN COPYRIGHT AND DATABASE RIGHT 2020
 © LOCAL GOVERNMENT INFORMATION HOUSE LIMITED COPYRIGHT AND DATABASE RIGHTS 2020

Rev	Reason for Issue	Date	Drw	Chk
0	Issue for DCO submission	24/12/20	EDP	ITS-S

THE LONDON RESORT DEVELOPMENT CONSENT ORDER
 REGULATION 5(2)(a) - TREES AND HEDGEROWS WHICH MAY BE REMOVED OR AFFECTED PLANS
 DARTFORD BOROUGH COUNCIL AND GRAVESHAM BOROUGH COUNCIL

Sheet 5 of 9

Application Number	BC080001
Drawing Reference	LR-PL-EDP-DCP-2.16.5
Scale	1:2500 @ A1
Sheet	5 of 9
Revision	0

DARTFORD BOROUGH COUNCIL

GRAVESHAM BOROUGH COUNCIL

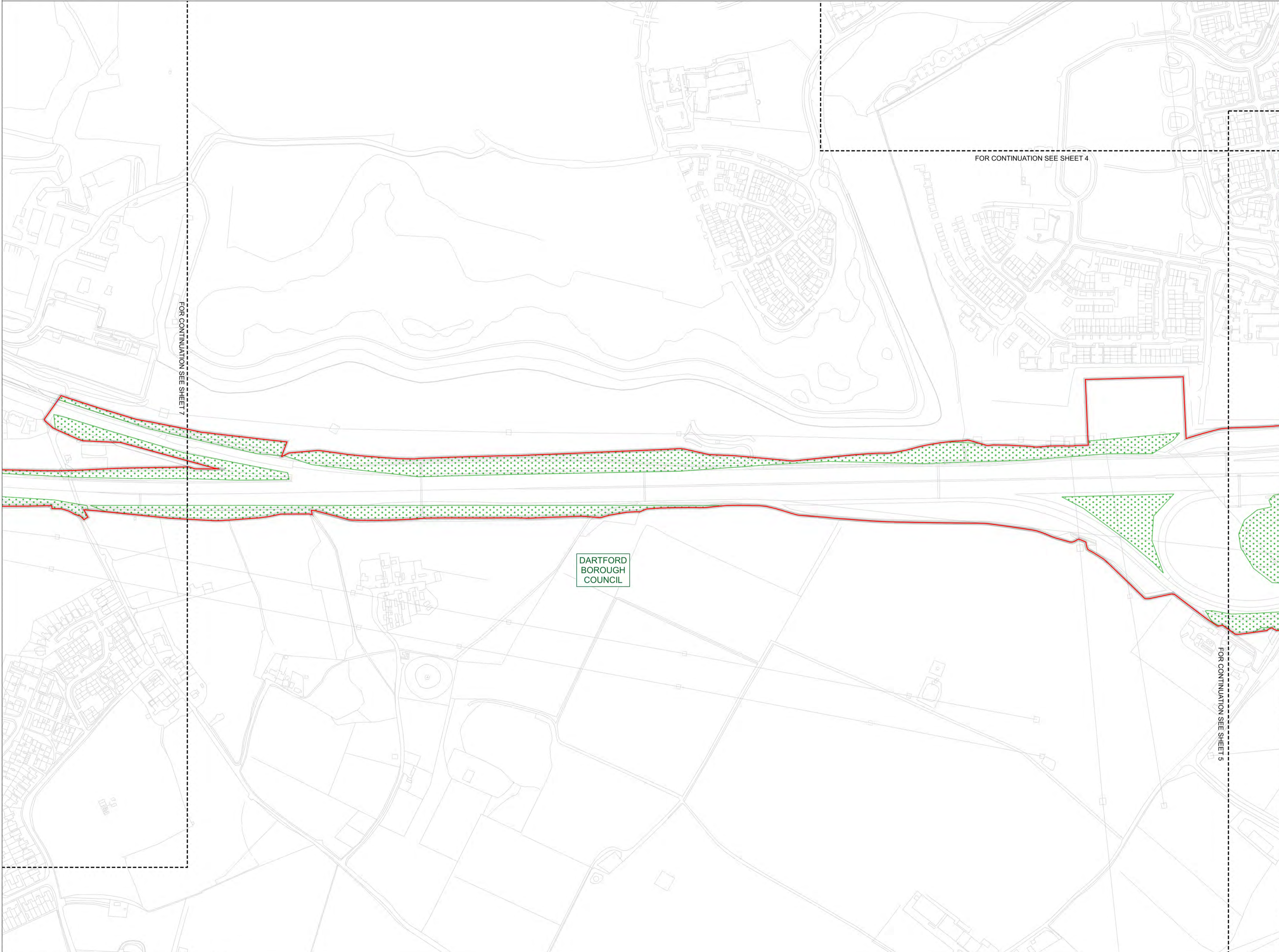
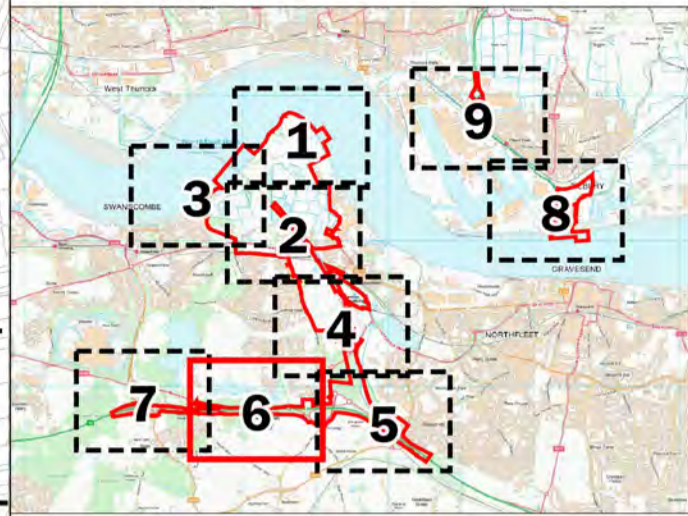
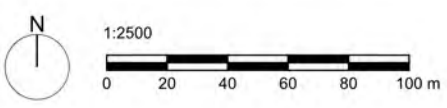

FOR CONTINUATION SEE SHEET 4

FOR CONTINUATION SEE SHEET 7

FOR CONTINUATION SEE SHEET 5

DARTFORD
BOROUGH
COUNCIL

Key

	Order Limits
	Areas of Trees and Hedgerows Proposed To Be Retained or Managed

Notes
 1) For further information of tree quality, loss and mitigation please see Environmental Impact Assessment Chapter 12, Appendix 12.9 Arboricultural Impact Assessment



Registered office: 01285 740427 - www.edp-uk.co.uk - info@edp-uk.co.uk

Project	The London Resort	Project No.	5988
---------	-------------------	-------------	------

Disclaimer
 Do not scale from this drawing. Check all dimensions on site before fabrication or setting out. This document is copyright and may not be reproduced without permission of the owner.

REPRODUCED FROM ORDNANCE SURVEY MAPS, BY PERMISSION OF THE ORDNANCE SURVEY ON BEHALF OF THE CONTROLLER OF HER MAJESTY'S STATIONARY OFFICE. CROWN COPYRIGHT ORDNANCE

ORDNANCE SURVEY EMAPSITE LICENSE NO. 0100031673

© CROWN COPYRIGHT AND DATABASE RIGHT 2020
 © LOCAL GOVERNMENT INFORMATION HOUSE LIMITED
 COPYRIGHT AND DATABASE RIGHTS 2020

Rev	Reason for Issue	Date	Drw	Chk
0	Issue for DCO submission	24/12/20	EDP	ITS-S

THE LONDON RESORT DEVELOPMENT CONSENT ORDER
 REGULATION 5(2)(a) - TREES AND HEDGEROWS WHICH MAY BE REMOVED OR AFFECTED PLANS
 DARTFORD BOROUGH COUNCIL

Sheet 6 of 9

Application Number	BC080001
Drawing Reference	LR-PL-EDP-DCP-2.16.6
Scale	1:2500 @ A1
Sheet	6 of 9
Revision	0

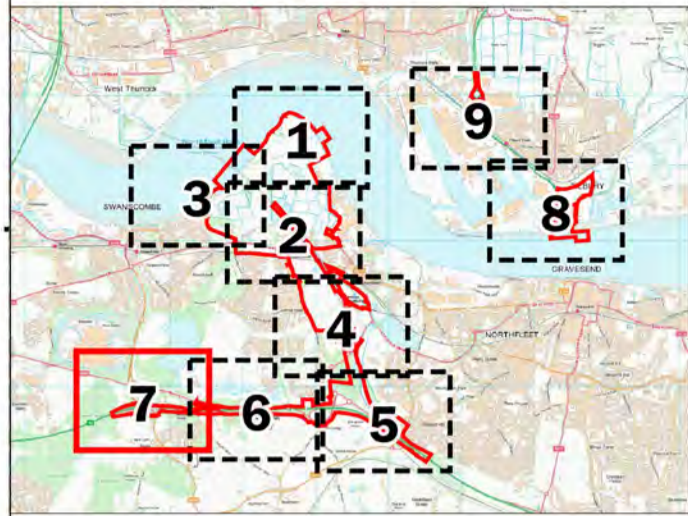
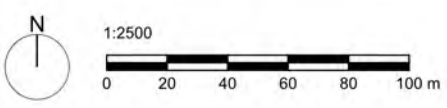

Key

	Order Limits
	Areas of Trees and Hedgerows Proposed To Be Retained or Managed
	Tree Preservation Order

Notes:
 1) For further information of tree quality, loss and mitigation please see Environmental Impact Assessment Chapter 12, Appendix 12.9 Arboricultural Impact Assessment



DARTFORD
BOROUGH
COUNCIL



Registered office: 01285 740427 - www.edp-uk.co.uk - info@edp-uk.co.uk

Project	The London Resort	Project No.	5988
---------	-------------------	-------------	------

Disclaimer
 Do not scale from this drawing. Check all dimensions on site before fabrication or setting out. This document is copyright and may not be reproduced without permission of the owner.

REPRODUCED FROM ORDNANCE SURVEY MAPS, BY PERMISSION OF THE ORDNANCE SURVEY ON BEHALF OF THE CONTROLLER OF HER MAJESTY'S STATIONARY OFFICE. CROWN COPYRIGHT ORDNANCE

ORDNANCE SURVEY EMAPSITE LICENSE NO. 0100031673

© CROWN COPYRIGHT AND DATABASE RIGHT 2020
 © LOCAL GOVERNMENT INFORMATION HOUSE LIMITED
 COPYRIGHT AND DATABASE RIGHTS 2020

Rev	Reason for Issue	Date	Drw	Chk
0	Issue for DCO submission	24/12/20	EDP	ITS-S

THE LONDON RESORT DEVELOPMENT CONSENT ORDER
 REGULATION 5(2)(a) - TREES AND HEDGEROWS WHICH MAY BE REMOVED OR AFFECTED PLANS
 DARTFORD BOROUGH COUNCIL

Sheet 7 of 9

Application Number
BC080001

Drawing Reference
LR-PL-EDP-DCP-2.16.7

Scale	Sheet:	Revision
1:2500 @ A1	7 of 9	0

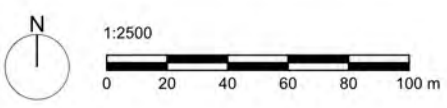

FOR CONTINUATION SEE SHEET 9

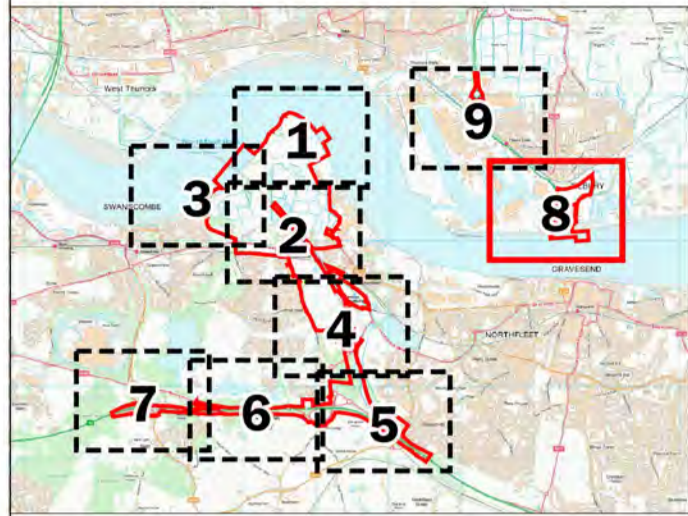

- Key**
- Order Limits
 - Local Authority Boundary
 - Area Outside Order Limits
 - Areas of Trees and Hedgerows Proposed To Be Retained or Managed
 - Individual Trees Which Will Be Removed
 - Areas of Trees and Hedgerows Which Will Be Removed

Notes:
 1) For further information of tree quality, loss and mitigation please see Environmental Impact Assessment Chapter 12, Appendix 12.9 Arboricultural Impact Assessment

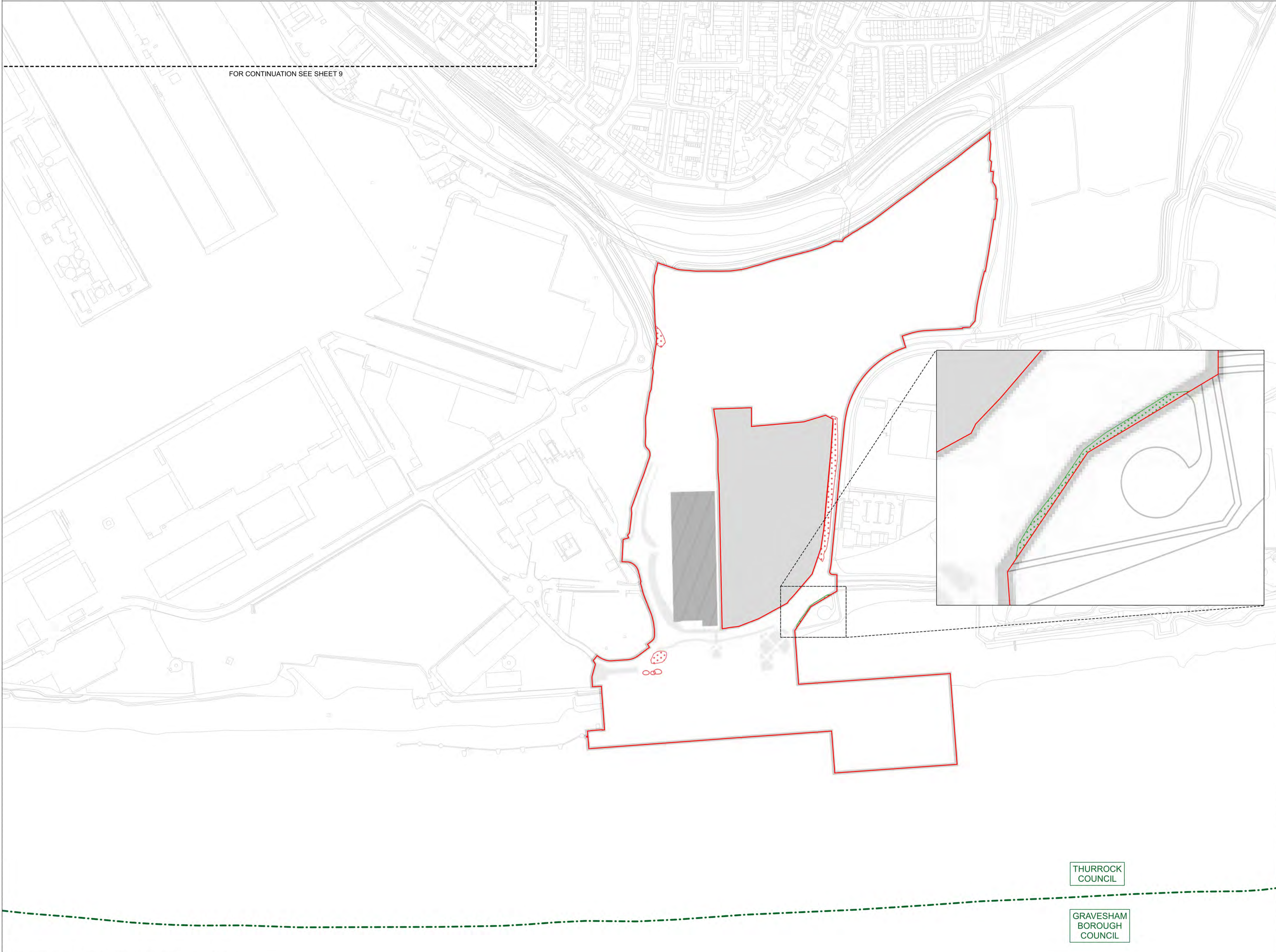

Registered office: 01285 740427 - www.edp-uk.co.uk - info@edp-uk.co.uk

Project	The London Resort	Project No.	5988
---------	-------------------	-------------	------

Disclaimer
 Do not scale from this drawing. Check all dimensions on site before fabrication or setting out. This document is copyright and may not be reproduced without permission of the owner.

REPRODUCED FROM ORDNANCE SURVEY MAPS, BY PERMISSION OF THE ORDNANCE SURVEY ON BEHALF OF THE CONTROLLER OF HER MAJESTY'S STATIONARY OFFICE. CROWN COPYRIGHT ORDNANCE

ORDNANCE SURVEY EMAPSITE LICENSE NO. 0100031673

© CROWN COPYRIGHT AND DATABASE RIGHT 2020
 © LOCAL GOVERNMENT INFORMATION HOUSE LIMITED
 COPYRIGHT AND DATABASE RIGHTS 2020

Rev	Reason for Issue	Date	Drw	Chk
0	Issue for DCO submission	24/12/20	EDP	ITS-S

THE LONDON RESORT DEVELOPMENT CONSENT ORDER
 REGULATION 5(2)(a) - TREES AND HEDGEROWS WHICH MAY BE REMOVED OR AFFECTED PLANS
 GRAVESHAM BOROUGH COUNCIL AND THURROCK COUNCIL

Sheet 8 of 8

Application Number
BC080001

Drawing Reference
LR-PL-EDP-DCP-2.16.8

Scale	Sheet:	Revision
1:2500 @ A1	8 of 9	0

THURROCK COUNCIL

GRAVESHAM BOROUGH COUNCIL

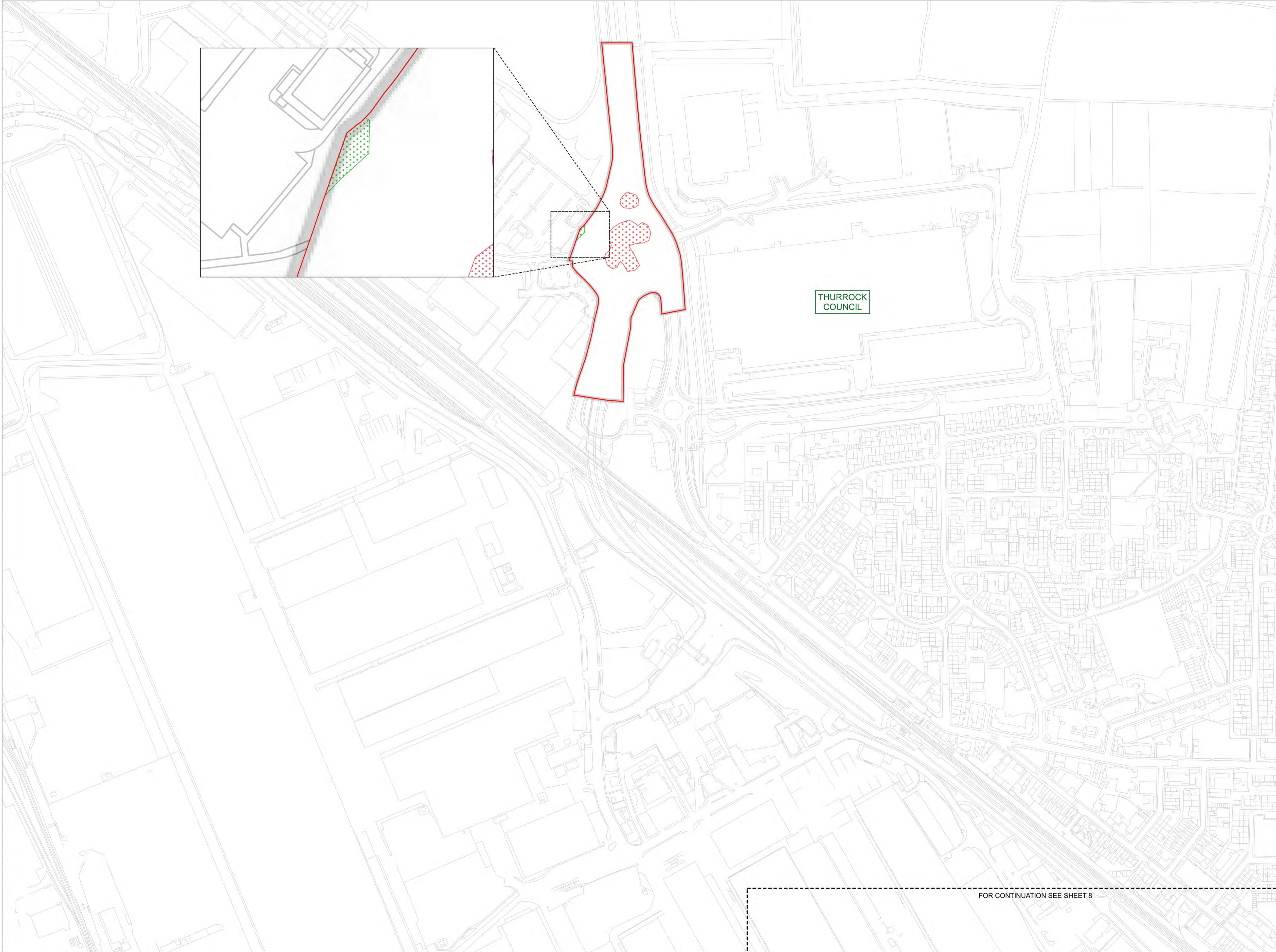
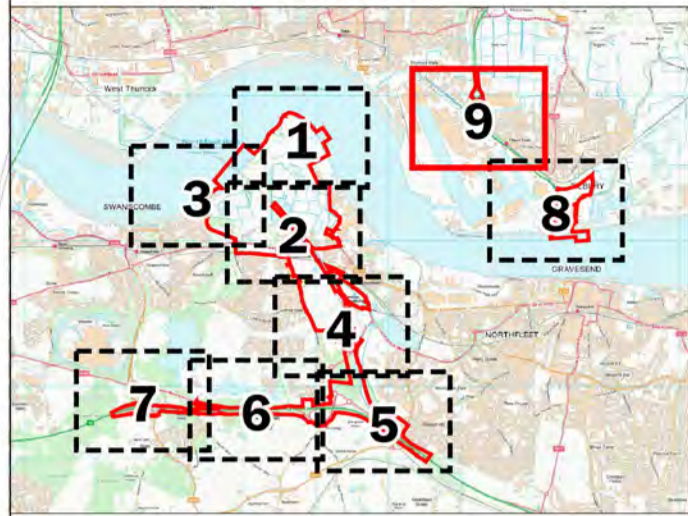
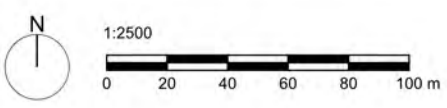

THURROCK COUNCIL

- Key
- Order Limits
 - Areas of Trees and Hedgerows Proposed To Be Retained or Managed
 - Areas of Trees and Hedgerows Which Will Be Removed

Notes:
 1) For further information of tree quality, loss and mitigation please see Environmental Impact Assessment Chapter 12, Appendix 12.9 Arboricultural Impact Assessment



Registered office: 01285 740427 - www.edp-uk.co.uk - info@edp-uk.co.uk

Project	The London Resort	Project No.	5988
---------	-------------------	-------------	------

Disclaimer
 Do not scale from this drawing. Check all dimensions on site before fabrication or setting out. This document is copyright and may not be reproduced without permission of the owner.

REPRODUCED FROM ORDNANCE SURVEY MAPS, BY PERMISSION OF THE ORDNANCE SURVEY ON BEHALF OF THE CONTROLLER OF HER MAJESTY'S STATIONARY OFFICE. CROWN COPYRIGHT ORDNANCE

ORDNANCE SURVEY EMAPSITE LICENSE NO. 0100031673

© CROWN COPYRIGHT AND DATABASE RIGHT 2020
 © LOCAL GOVERNMENT INFORMATION HOUSE LIMITED
 COPYRIGHT AND DATABASE RIGHTS 2020

Rev	Issue for DCO submission	Reason for Issue	Date	Drw	Chk
0	Issue for DCO submission		24/12/20	EDP	ITS-S

THE LONDON RESORT DEVELOPMENT CONSENT ORDER
 REGULATION 5(2)(a) - TREES AND HEDGEROWS WHICH MAY BE REMOVED OR AFFECTED PLANS

THURROCK COUNCIL

Sheet 9 of 9

FOR CONTINUATION SEE SHEET 8

Application Number	BC080001
Drawing Reference	LR-PL-EDP-DCP-2.16.9
Scale	1:2500 @ A1
Sheet	9 of 9
Revision	0